

Approx Gross Internal Area
32 sq m / 346 sq ft

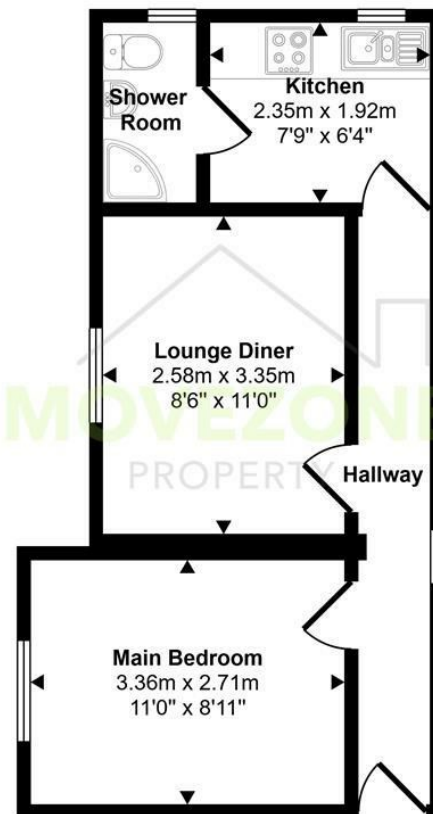

Floorplan

This floorplan is only for illustrative purposes and is not to scale. Measurements of rooms, doors, windows, and any items are approximate and no responsibility is taken for any error, omission or mis-statement. Icons of items such as bathroom suites are representations only and may not look like the real items. Made with Made Snappy 360.

Directions

Contact

223 Southborough Lane
Bromley
Kent
BR2 8AT

E: info@movezone.co.uk

T: 0208 3139075

<https://www.movezone.co.uk>



**1 Bed
Flat
located in Belvedere**



37 Heron Hill
Belvedere
London
DA17 5HE

£1,150 PCM



We are pleased to offer for rental this one-bedroom unfurnished flat, forming part of a recently converted property just a short walk from Belvedere Station and the High Street. Well positioned for local transport and amenities, this home is expected to let very quickly.

The accommodation comprises a double bedroom, a spacious lounge, a modern fitted kitchen with appliances, and a modern shower room off the kitchen. The property is neutrally decorated throughout and further benefits from double glazing and gas central heating.

The contingency deposit is £1,326.00
EPC Rating: C
Council Tax Band: B

Don't miss the opportunity to call this beautiful flat your new home!

